

## SHURJOINT SHOULDERED PIPING SYSTEM

The **Shurjoint** shouldered piping system is a classic and versatile piping method used for a wide range of applications including irrigation, dewatering on construction sites, and other installations, etc. The shouldered system features full flow characteristics, provides speed and ease of installation, and proven reliability. The system provides for limited expansion and contraction and accommodates some linear and angular movement. Each joint is a union.

The **Shurjoint** shouldered piping system utilizes Type A weld-on rings, manufactured from mild steel or material compatible to pipe end used.

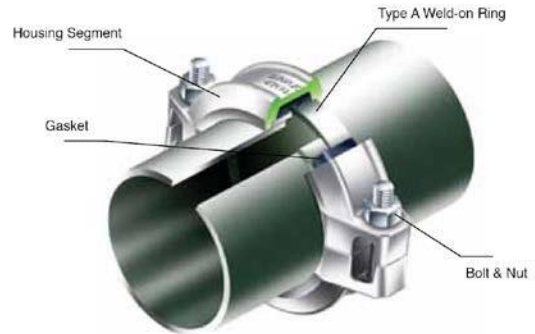

### Shoulder Dimensions (Type "A" Weld-on Rings)

The **Shurjoint** shouldered piping system utilizes Type A weld-on rings, manufactured from mild steel or material compatible to pipe end used. Type A rings are suitable for services up to maximum 600 psi / 40 bar for sizes up to 4" / 100mm and 400 psi / 28 bar for 5" / 125mm through 8" / 200mm.

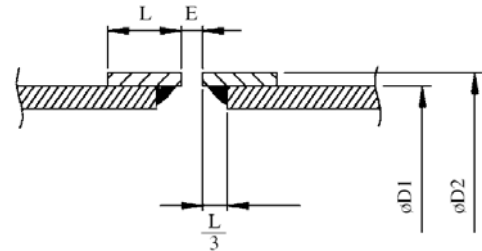

Shoulder Dimensions (Type "A" Weld-on Rings)				
Nominal Size	Pipe OD D1	Shoulder Diameter D2	Shoulder Length L	Nominal Gap E
in	in	in	in	in
mm	mm	mm	mm	mm
2	2.375	2.62	0.63	0.13
50	60.3	66.5	16.0	3.2
3	3.500	3.82	0.63	0.13
80	88.9	97.0	16.0	3.2
4	4.500	4.80	0.69	0.13
100	114.3	122.0	17.5	3.2
165.1 mm	6.500	6.87	0.69	0.13
	165.1	174.5	17.5	3.2
6	6.625	7.00	0.69	0.13
150	168.3	178.0	17.5	3.2
8	8.625	9.13	0.81	0.13
200	219.1	232.0	20.6	3.2